

BRAVIA Professional Displays

2021 Model Catalog

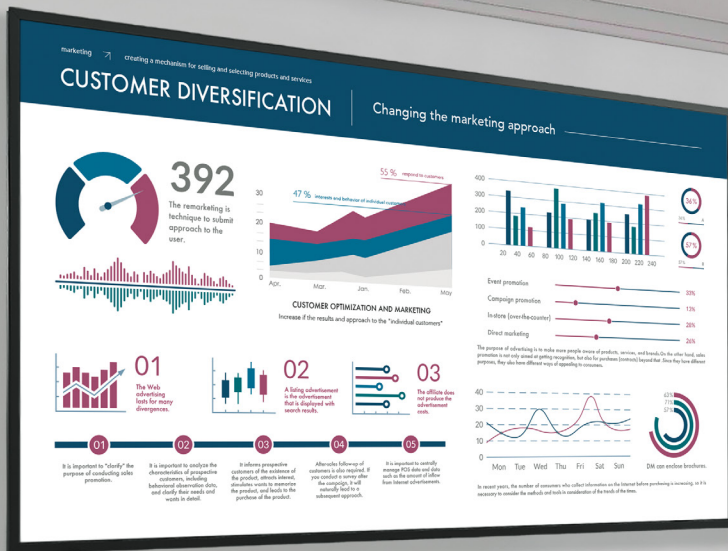

BRAVIA



X|R
Cognitive Processor

X|1
4K HDR Processor



Extron

logitech

Outstanding picture quality & detailed reproduction for business



BRAVIA™

Harness the power of rich media content for your organization with BRAVIA Professional Displays.

androidtv



Cognitive Processor XR™

World's first processor with Cognitive Intelligence

Our BRAVIA XR Display takes vision and sound to the next level with the ingenious Cognitive Processor XR. It understands how humans see and hear, providing a whole new experience that immerses you completely in the scene.

4K HDR Processor X1™

One chip, incredibly real

With Object-based HDR remaster and 4K HDR technology, our new 4K HDR Processor X1 reproduces more depth, textures and natural colors than Sony's entry level 4K Processor X1. You'll see pure colors at higher brightness levels for exceptionally realistic pictures.



X1
4K HDR Processor

Cognitive Processor XR™

XR Color

A wide palette of naturally beautiful colors

See colors that are natural and beautiful to the human eye. The Cognitive Processor XR enables our unique display to access a wider palette and reproduce each color with the subtle differences seen in the real world. With extended hue and saturation, vivid shades and realistic texture can be seen.



XR Picture

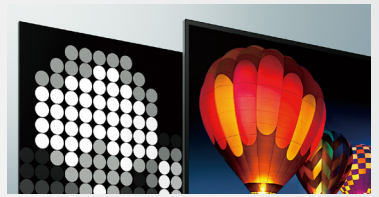
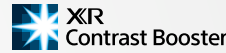

XR Motion

Intelligent motion processing for fast-moving, blur-free scenes

Watching fast-moving movies just got a whole lot better. Our Cognitive Processor XR with XR Motion Clarity™ cross analyses data to ensure action stays smooth, bright and clear with no blur.

XR Contrast

Real life depth with deep blacks and intense brightness

Feel breathtaking contrast, just as in real life. Our Cognitive Processor XR cross analyzes data, enhancing pictures in the same way that the human eye focuses for real life color and depth. With XR Contrast Booster, bright areas are brighter and dark areas darker -eliminating details overwhelmed by shadow or lost in blown-out highlights.

4K HDR Processor X1™

Picture

Unique 4K X-Reality PRO picture processing technology upscales every pixel for remarkable clarity. Advanced noise reduction techniques and a special pattern database ensure every scene is full of lifelike detail.

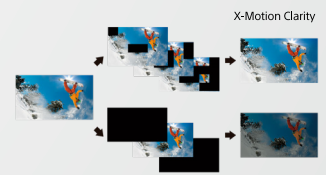
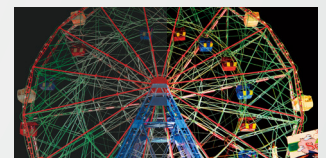
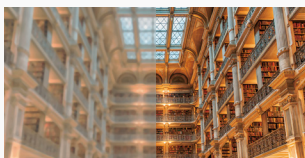

Color

By widening the color spectrum, TRILUMINOS powered by our X1 processors reproduces more colors than a conventional display. It analyzes and processes data in every image to make colors even more natural and precise so pictures are closer than ever to real life.

Clarity

On some screens, sports and fast-action scenes can seem to go by in a blur. Our latest X-Motion Clarity™ technology keeps everything smooth, bright, and clear. Each "blink" is individually controlled and its duration optimized, while brightness is boosted when needed, so you won't miss a thing.

Expanding the possibility of your business with the new lineup of BRAVIA Professional Displays

Newly added 100" & 32" size broaden the lineup to match to any installation locations. The new Standard product line brings a wide options for business application environment.



Sony's largest professional display model with supreme picture quality features

100" **NEW**

The new 100" BZ40J delivers supreme picture quality, high contrast, and more detail for large-sized digital signage and meeting rooms.



Features for Professional Use



Professional Mode

New professional features let you disable input or remote control, remove labels and block buttons; customize and store display settings and features, add security then copy them easily from display to display via USB flash memory.



Flexible Content Layout with HTML5

The BZ Series offers built-in support for the HTML5 application platform, so it's possible to use HTML5 interactive signage content without requiring a set-top box or PC. The content screen can be freely laid out using the 4K video, pictures, or even with the HDMI input.

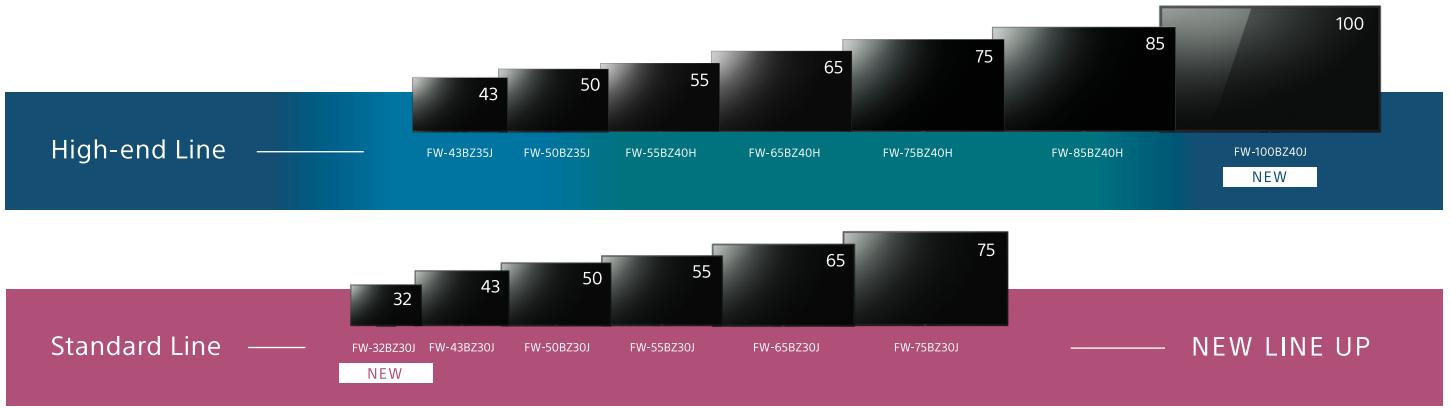

Small,
high picture quality 32"
4K display model

NEW 32"

Small in size, but big in picture quality for meeting contents details even in huddle space environment with new 32" BZ30J



X1
4K HDR Processor

Professional Design

Suitable designs for professional use such as Digital Signage

Logo Position for Public Installation

Sony logo is printed to top-right side bezel for public installation such as digital signage and it eliminates the sideways logo in portrait orientation.



Four-sided Uniform Bezel for Portrait Installation

* for BZ40J only

Carrying Handle

* for BZ40J only

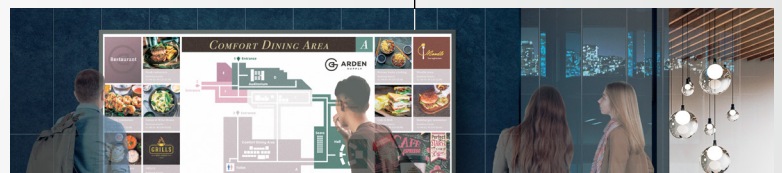

Cable Management

Neatly bundles the power cable, HDMI and other cables with a cable clasper



32" AC Adapter Holder

Smart installation by adapter holder even in limited space

* for BZ30J only



IP Network and Serial Communication Controls

The BZ Series is controllable both via IP network (wired/wireless LAN) and RS-232C. This makes it possible to incorporate the displays into a variety of existing systems, such as in offices and as eye-catching signage.

Wi-Fi 5Ghz / Apple AirPlay & Chromecast built-in™

Discover a new world of possibilities with the new BRAVIA functionality. Easily mirror content onto your BRAVIA Pro Display using Apple AirPlay or Chromecast built-in, and take advantage of Wi-Fi 5Gz connection.



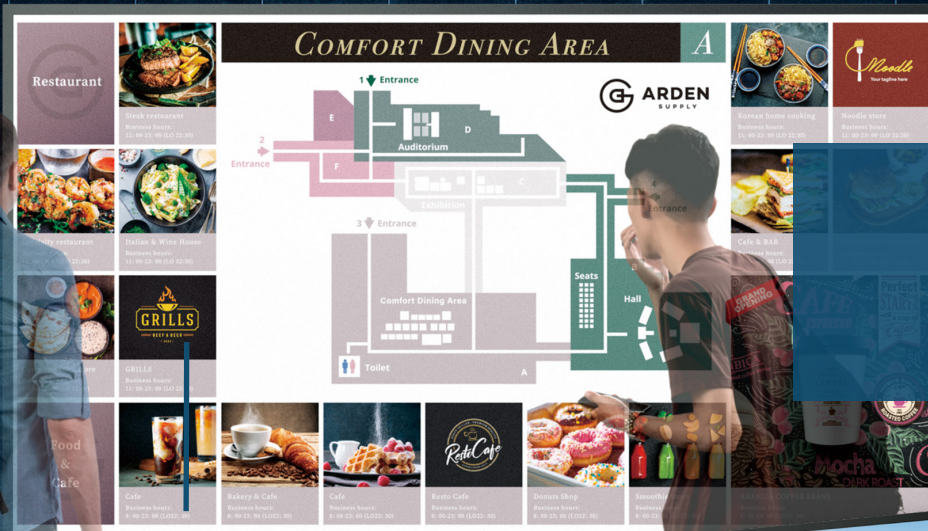

Our largest size screen model with Cognitive Processor XR & Supreme Picture Quality

Peak Brightness : 940cd/m²



Cognitive Processor XR™

The BZ40J incorporates the Cognitive Processor XR that uses human perspective analysis to cross analyze thousands of elements at one to create an intensely immersive picture.



BRAVIA XR



XR Triluminos Pro

Powered by our Cognitive Processor XR, this display reproduces color in a way that humans find beautiful. See a wider palette of colors with an enhanced range of hue and saturation, allowing natural shades and precise details to be seen, even in dark scenes.



XR 4K Upscaling

Powered by our Cognitive Processor XR, this display takes 2K signals close to true 4K quality for incredibly real and immersive viewing. XR 4K Upscaling accesses and utilizes a vast amount of data, analyzing patterns in scenes and recreating subtle details.

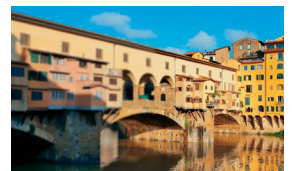

XR Motion Clarity™

On some screens, fast-moving scenes can seem to go by in a blur. Our latest LED XR X-Motion Clarity technology keeps everything smooth, bright and clear. Each frame is individually controlled and its duration optimized, while brightness is boosted when needed, so you won't miss a thing.



XR Contrast Booster

By precisely balancing light output across the screen, dimming some areas and boosting others, the XR Contrast Booster adjusts brightness for higher peaks in glare and deeper blacks in shadows. As bright areas are brighter and dark areas darker, scenes look more real with extra depth and detail.

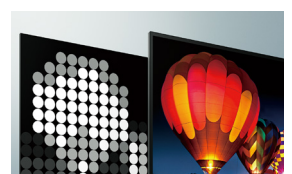

24/7 • Portrait • Tilt



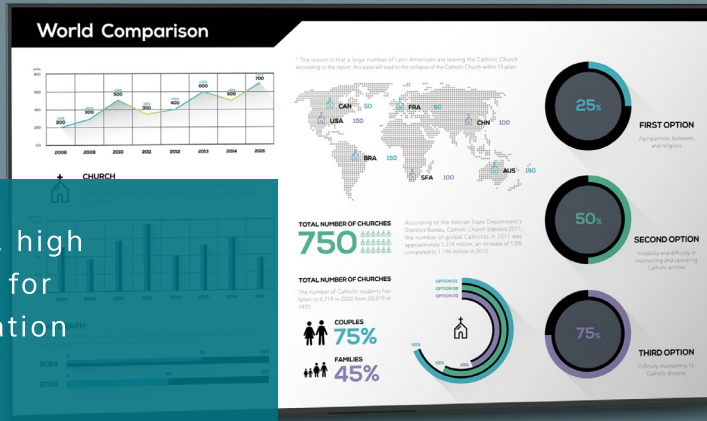

High brightness, high contrast images for business application content

Peak Brightness : 850 cd/m²



Picture Quality Features



Full Array LED

Brighter highlights and deeper blacks

Multiple LED zoning allows Full Array display models to adjust and create contrast depending on the scene, resulting in more light where brightness is needed, and less light where darkness is needed.

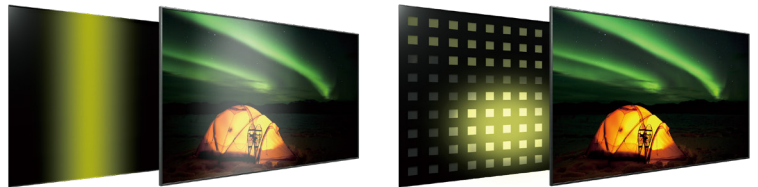

Cosmetic Design



Logo position



All Side Terminal Position



Flat bottom bezel

24/7 • Portrait • Tilt



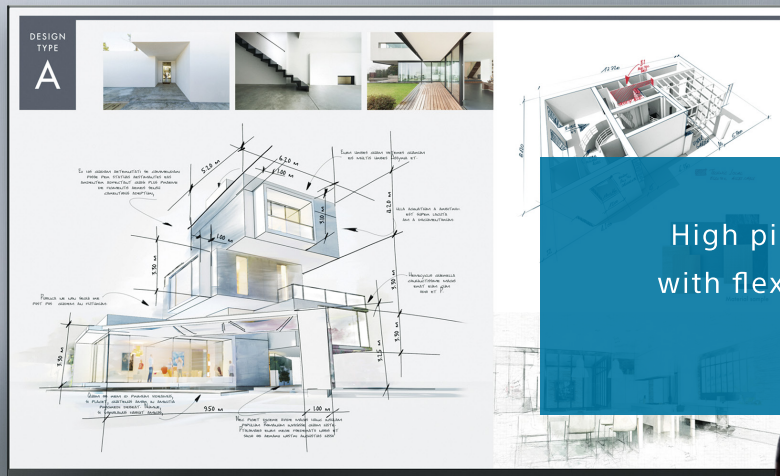

High picture quality model with flexible installation for mid-sized spaces



Picture Quality Features



Motionflow XR

Less blur, even in fast scenes

On some screens, sports and fast action scenes go by in a blur. Our Motionflow technology keeps movement smooth and clear by creating extra images between images and black images between scenes. The result? Less blur and afterimage, more flowing motion.



Cosmetic Design



Logo position



All Side Terminal Position



Flat bottom bezel

24/7·Portrait·Tilt



BZ30J

Features — 2021 NEW Model

| | | |
|-----|-----|-----|
| 75" | 65" | 55" |
| 50" | 43" | 32" |

androidtv



Standard lineup including space saving size for more implementation options in business use



Picture Quality Features



Color Reproduction

Our displays with a wide colourgamut and unique TRILUMINOS PRO™ algorithm can detect colourfrom saturation, hue and brightness to reproduce natural shades in every detail. You'll enjoy coloursthat are closer to those seen in the real world.



Cosmetic Design



Logo position



75"-43"



75"-32"

All Side Terminal Position

24/7·Portrait·Tilt



BZ-series Specifications

High-end Line

| | | FW-100BZ40J | FW-85BZ40H | FW-75BZ40H | FW-65BZ40H | FW-55BZ40H | FW-50BZ35J | FW-43BZ35J | | |
|--------------------------------|--|--|--|------------------------|----------------------|----------------------|--|----------------------|--|--|
| General features | Screen Size | 100" | 85" | 75" | 65" | 55" | 50" | 43" | | |
| | Brightness (cd/m ²) | Typ. 600 / Peak 940 | Typ. 620 / Peak 850 | | | | 570 | 560 | | |
| | Native contrast ratio | 9,000:1 | 4,000:1 | 6,000:1 | | | 5,000:1 | 4,000:1 | | |
| | Dynamic contrast ratio | 600,000:1 | 600000:1 | | 550000:1 | | 500,000:1 | 400,000:1 | | |
| | Response Time (ms) | 7 | 6 | 8 | | | 6 | | | |
| | Display resolution (H x V, pixels) | 3,840 x 2,160 | | | | | | | | |
| | HDR (High Dynamic Range) compatibility | Yes (HDR10, HLG, Dolby Vision) | | | | | | | | |
| | Aspect Ratio | 16:9 | | | | | | | | |
| Portrait/Tilt Compatibility *1 | Yes | | | | | | | | | |
| Display features | Dimming type | Local Dimming | | | | | Frame Dimming | | | |
| | Display device | LCD | | | | | | | | |
| | Backlight type | Direct (Full Array LED) | Direct (Full Array LED) | | | | | Direct LED | | |
| | 4K Processor | Cognitive Processor XR | 4K HDR Processor X1 | | | Direct LED | | | | |
| | Operation time | 24/7 | 24/7 | | | 24/7 | | | | |
| Video Specs | Wide Mode | Wide Zoom/Normal/Full/Zoom | Auto/Wide Zoom/Normal/Full/Zoom | | | | Wide Zoom / Normal / Full / Zoom | | | |
| | 4:3 Default | Yes | | | | | | | | |
| | Video Processing | XR 4K Upscaling | 4K X-Reality PRO | | | | | | | |
| | Motion enhancer | XR Motion Clarity, Auto mode | X-Motion Clarity, Auto mode | | | | Motionflow XR 960Hz (Native 120Hz), Auto mode | | | |
| | TRILUMINOS Display | XR Triluminos Pro | TRILUMINOS DISPLAY | | | | TRILUMINOS PRO | | | |
| | Viewing Angle (Right/Left) | 178 (89/89) degree | | | | | | | | |
| | Viewing Angle (Up/Down) | 178 (89/89) degree | | | | | | | | |
| | HDMI Signal | 4096x2160p(24, 60Hz), 3840x2160p(24, 30, 60, 120Hz), 1080p(30, 60, 120Hz), 1080i(60Hz), 720p(30, 60Hz), 720i(60Hz), 480p | 4096x2160p (24, 60Hz), 3840x2160p (24, 30, 60, 120Hz), 1080p (30, 60, 120Hz), 1080i (60Hz), 720p (30, 60Hz), 720i (60Hz), 480p | | | | 4096x2160p (24, 60Hz), 3840x2160p (24, 30, 60, 120Hz), 1080p (30, 60, 120Hz), 1080i (60Hz), 720p (30, 60Hz), 720i (60Hz), 480p | | | |
| Audio Specs | Speaker Position | Down Firing | Side Back + Down Firing | | | | Down Firing | | | |
| | Audio Power Output | 10W + 10W | | | | | | | | |
| Professional features | Professional Hidden mode | Pro Mode | | | | | | | | |
| | HDMI auto wake-up | Yes | | | | | | | | |
| | HTML5 platform | Yes | | | | | | | | |
| | Multicast/IPTV | Yes | | | | | | | | |
| | Operating System*2 | Android 10 | Android 9.0 Pie | | | | Android 10 | | | |
| | On-board Storage (GB) | 16GB*3 | | | | | | | | |
| Network Specs | Wi-Fi Direct | Yes | | | | | | | | |
| | Wi-Fi Certified | Yes | | | | | | | | |
| | Wireless LAN | Integrated | | | | | | | | |
| Convenience features | USB playback codecs | MPEG1:MPEG1 / MPEG2PS:MPEG2 / MPEG2TS(HDV, AVCHD):MPEG2, AVC / MP4(XAVC S):AVC, MPEG4, HEVC / AVI:Xvid, MotionJpeg / ASF(WMV):VC1 / MOV:AVC, MPEG4, MotionJpeg / MKV:Xvid, AVC, MPEG4, VP8, HEVC / WEBM:VP8 / 3GPP:MPEG4, AVC / MP3 / ASF(WMA) / LPCM / WAV / MP4AAC / FLAC / JPEG | | | | | | | | |
| | On Screen Clock | Yes | | | | | | | | |
| | Sleep Timer | Yes | | | | | | | | |
| | On/Off Timer | Yes | | | | | | | | |
| | Chromecast built-in | Yes | | | | | | | | |
| | Apple AirPlay (Internet required) | Yes | | | | | | | | |
| | Control Specs | IP Control | Yes | | | | | | | |
| RS-232C Control | | 1 (Side) | | | | | | | | |
| HDMI-CEC | | Yes | | | | | | | | |
| Inputs and outputs | HDCP | HDCP2.3 (for HDMI1/2/3/4) | | | | | | | | |
| | Composite Video Input (s) | 1 (Side, Mini jack) | | | | | | | | |
| | HDMI inputs total | 4 (4Side) | | | | | | | | |
| | Analog Audio Input (s) (Total) | 1 (Side Analog Conversion) | | | | | | | | |
| | Digital Audio Output (s) | 1 (Side) | | | | | | | | |
| | USB ports | 2 (Side) | | | | | | | | |
| | Ethernet inputs | 1 (Side) | | | | | | | | |
| Design features | Frame color | Black | | | | | | | | |
| | Stand Design | Slim Blade Stand | Metal Blade Stand | | | | Slim Blade Stand | | | |
| | VESA® Hole Spacing Compatible | Yes | | | | | | | | |
| Environment specs | VESA® Hole Pitch (W x H) | 600 x 400 mm | 400 x 400 mm | 300 x 300 mm | | | 200 x 200 mm | | | |
| | Screen Size for WEB (diagonal, cm, integer or 1st decimal) | 253 cm | 215.0 cm | 189.0 cm | 164.0 cm | 139.0 cm | 126 cm | 108 cm | | |
| | Rated Power Consumption | 426 W | 318W | 277W | 214W | 173W | 148 W | 114 W | | |
| | Power Consumption (in Standby) | 0.5 W | | | | | | | | |
| Measurements | Dynamic Backlight Control | Yes | | | | | | | | |
| | Power Saving Mode / Back Light Off Mode | Yes | | | | | | | | |
| | Dimension of TV without Stand (W x H x D) | 2,260 x 1,297 x 98 mm | 1,899 x 1,089 x 72 mm | 1,674 x 961 x 71 mm | 1,450 x 833 x 70 mm | 1,231 x 710 x 70 mm | 1,119 x 649 x 70 mm | 964 x 563 x 69 mm | | |
| | Dimension of TV with Stand (W x H x D) | 2,260 x 1,346 x 475 mm | 1,899 x 1,162 x 441 mm | 1,674 x 1,034 x 410 mm | 1,450 x 903 x 338 mm | 1,231 x 780 x 338 mm | 1,119 x 715 x 286 mm | 964 x 628 x 286 mm | | |
| Weight | Dimension of Package Carton (W x H x D) | 2,440 x 1,558 x 378 mm | 2,036 x 1,232 x 258 mm | 1,810 x 1,107 x 186 mm | 1,574 x 958 x 184 mm | 1,348 x 833 x 160 mm | 1,225 x 782 x 141 mm | 1,070 x 695 x 141 mm | | |
| | Weight of TV without Stand | 88.9 kg | 45.8 kg | 32.9 kg | 22.2 kg | 16.5 kg | 12.7 kg | 10.2 kg | | |
| | Weight of TV with Stand | 92.6 kg | 47.7 kg | 34.4 kg | 23.2 kg | 17.5 kg | 13.3 kg | 10.7 kg | | |
| | Weight of Package Carton (Gross) | 129 kg | 62kg | 46kg | 31kg | 23kg | 19 kg | 14 kg | | |

BZ-series Specifications

Standard Line

| | | FW-75BZ30J | FW-65BZ30J | FW-55BZ30J | FW-50BZ30J | FW-43BZ30J | FW-32BZ30J | |
|--------------------------------|--|---|----------------------|----------------------|----------------------|----------------------|--------------------|-----------|
| General features | Screen Size | 75" | 65" | 55" | 50" | 43" | 32" | |
| | Brightness (cd/m ²) | 440 | | | | | 300 | |
| | Native contrast ratio | 1,200:1 | | | 5,000:1 | | 1,200:1 | 3,000:1 |
| | Dynamic contrast ratio | 300,000:1 | | | | | 400,000:1 | 260,000:1 |
| | Response Time (ms) | 11 | | 10 | | 9 | 10 | |
| | Display resolution (H x V, pixels) | 3,840 x 2,160 | | | | | | |
| | HDR (High Dynamic Range) compatibility | Yes (HDR10, HLG, Dolby Vision) | | | | | | |
| | Aspect Ratio | 16:9 | | | | | | |
| Portrait/Tilt Compatibility *1 | Yes | | | | | | | |
| Display features | Dimming type | Frame Dimming | | | | | | |
| | Display device | LCD | | | | | | |
| | Backlight type | Direct LED | | | | | Edge LED | |
| | 4K Processor | 4K HDR Processor X1 | | | | | | |
| | Operation time | 24/7 | | | | | | |
| Video Specs | Wide Mode | Wide Zoom / Normal / Full / Zoom | | | | | | |
| | 4:3 Default | Yes | | | | | | |
| | Video Processing | 4K X-Reality PRO | | | | | | |
| | Motion enhancer | Motionflow XR 240Hz (Native 60Hz), Auto mode | | | | | | |
| | TRILUMINOS Display | TRILUMINOS PRO | | | | | | |
| | Viewing Angle (Right/Left) | 178 (89/89) degree | | | | | | |
| | Viewing Angle (Up/Down) | 178 (89/89) degree | | | | | | |
| | HDMI Signal | 4096x2160p (24, 60Hz), 3840x2160p (24, 30, 60Hz), 1080p (30, 60Hz), 1080/24p, 1080i (60Hz), 720p (30, 60Hz), 720/24p, 480p | | | | | | |
| Audio Specs | Speaker Position | Down Firing | | | | | | |
| | Audio Power Output | 10W + 10W | | | | | 5W + 5W | |
| Professional features | Professional Hidden mode | Pro Mode | | | | | | |
| | HDMI auto wake-up | Yes | | | | | | |
| | HTML5 platform | Yes | | | | | | |
| | Multicast/IPTV | Yes | | | | | | |
| | Operating System*2 | Android 10 | | | | | | |
| | On-board Storage (GB) | 16GB*3 | | | | | | |
| Network Specs | Wi-Fi Direct | Yes | | | | | | |
| | Wi-Fi Certified | Yes | | | | | | |
| | Wireless LAN | Integrated | | | | | | |
| Convenience features | USB playback codecs | MPEG1:MPEG1 / MPEG2PS:MPEG2 / MPEG2TS(HDV, AVCHD):MPEG2, AVC / MP4(XAVC S):AVC, MPEG4, HEVC / AVI:Xvid, MotionJpeg / ASF(WMV):VC1 / MOV:AVC, MPEG4, MotionJpeg / MKV:Xvid, AVC, MPEG4, VP8.HEVC / WEBM:VP8 / 3GPP:MPEG4, AVC / MP3 / ASF(WMA) / LPCM / WAV / MP4AAC / FLAC / JPEG | | | | | | |
| | On Screen Clock | Yes | | | | | | |
| | Sleep Timer | Yes | | | | | | |
| | On/Off Timer | Yes | | | | | | |
| | Chromecast built-in | Yes | | | | | | |
| | Apple AirPlay (Internet required) | Yes | | | | | | |
| Control Specs | IP Control | Yes | | | | | | |
| | RS-232C Control | 1 (Side) | | | | | | |
| | HDMI-CEC | Yes | | | | | | |
| Inputs and outputs | HDCP | HDCP2.3 (for HDMI1/2/3/4) | | | | | | |
| | Composite Video Input (s) | 1 (Side, Mini jack) | | | | | | |
| | HDMI inputs total | 4 (4Side) | | | | | | |
| | Analog Audio Input (s) (Total) | 1 (Side Analog Conversion) | | | | | | |
| | Digital Audio Output (s) | 1 (Side) | | | | | | |
| | USB ports | 2 (Side) | | | | | | |
| | Ethernet inputs | 1 (Side) | | | | | | |
| Design features | Frame color | Black | | | | | | |
| | Stand Design | Slim Blade Stand | Slim Blade Stand | Slim Blade Stand | Slim Blade Stand | Slim Blade Stand | Stand | |
| | VESA® Hole Spacing Compatible | Yes | Yes | Yes | Yes | Yes | Yes | |
| | VESA® Hole Pitch (W x H) | 300 x 300 mm | | | 200 x 200 mm | | 100 x 200 mm | |
| Environment specs | Screen Size for WEB (diagonal, cm, integer or 1st decimal) | 189 cm | 164 cm | 139 cm | 126 cm | 108 cm | 80 cm | |
| | Rated Power Consumption | 297 W | 230 W | 196 W | 146 W | 107 W | 66 W | |
| | Power Consumption (in Standby) | 0.5 W | 0.5 W | 0.5 W | 0.5 W | 0.5 W | 0.5 W | |
| | Dynamic Backlight Control | Yes | | | | | | |
| | Power Saving Mode / Back Light Off Mode | Yes | | | | | | |
| Measurements | Dimension of TV without Stand (W x H x D) | 1,686 x 969 x 72 mm | 1,462 x 842 x 71 mm | 1,243 x 719 x 71 mm | 1,126 x 653 x 70 mm | 972 x 567 x 70 mm | 726 x 430 x 76 mm | |
| | Dimension of TV with Stand (W x H x D) | 1,686 x 1,045 x 410 mm | 1,462 x 912 x 338 mm | 1,243 x 787 x 338 mm | 1,126 x 718 x 286 mm | 972 x 632 x 286 mm | 726 x 454 x 172 mm | |
| | Dimension of Package Carton (W x H x D) | 1,824 x 1,114 x 187 mm | 1,588 x 965 x 184 mm | 1,362 x 840 x 160 mm | 1,240 x 796 x 141 mm | 1,070 x 695 x 141 mm | 814 x 551 x 152 mm | |
| Weight | Weight of TV without Stand | 31.6 kg | 21.6 kg | 15.7 kg | 12.3 kg | 10 kg | 7.5 kg | |
| | Weight of TV with Stand | 32.9 kg | 22.5 kg | 16.6 kg | 12.9 kg | 10.5 kg | 7.7 kg | |
| | Weight of Package Carton (Gross) | 49 kg | 31 kg | 23 kg | 17 kg | 14 kg | 10 kg | |

*1 Please refer "Wall-Mount Installation Manual" for condition details *2 As of June, 2021 *3 The actual capacity available to the user will vary depending on OS and installed software requirements. Google, Google Play, Android TV, Chromecast built-in and other marks are trademarks of Google LLC.

Options & Accessories



BRAVIA Meeting (WQ-BM1)

BRAVIA Meeting enables centralized management of displays and interactive meetings via a network. The optional software, BRAVIA Meeting, enables remote monitoring of multiple displays, power control, and configuration changes. In addition, displaying PC screen shots wirelessly and annotation which enhances in-meeting collaboration.

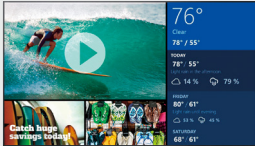

BRAVIA Signage (WQ-BS1)

BRAVIA Signage simplifies management and distribution of signage content across multiple networked BRAVIA displays. Group displays, schedule content ployout and more – everything's included with this highly flexible package.



BRAVIA Signage Free (WQF-BS1F)

BRAVIA Signage Free is an easy-to-use standalone signage player application, allowing you to display video, photos and HTML5 content directly from a connected USB flash memory. It's quick and intuitive to set up screens, edit and preview playlists and schedules using the BRAVIA display's remote controller.



FWA-CE100

Full HD USB Camera & Microphone exclusively designed for BRAVIA 4K Professional Displays.



STP-IR200 Series

Touch overlay kit for 55", 65", 75" BRAVIA 4K Professional Displays.

For full features visit pro.sony/displays

© 2021 Sony Corporation. All rights reserved. Reproduction in whole or in part without permission is prohibited. Features and specifications are subject to change without notice. All non-metric weights and measurements are approximate. 'Sony' and 'BRAVIA' are registered trademarks or trademarks of Sony Corporation. All other trademarks are the property of their respective owners.

Distributed by

SONY